

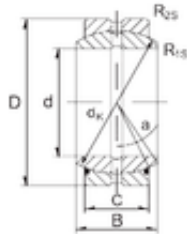

NACHI BEARINGS OF AMERICA CORP.

16 mm x 30 mm x 14 mm ZEN GE16ES2RS
plain bearings



Bearing No. GE16ES2RS

Size	16x30x14 mm
Bore Diameter	16 mm
Outer Diameter	30 mm
Width	14 mm
d	16 mm
D	30 mm
B	14 mm
C	10 mm
dk	25 mm
r1 min.	0,3 mm
r2 min.	0,3 mm
Angle	10 °
Weight	0,041 Kg
Basic dynamic load rating (C)	21 kN

GE16ES2RS Bearing 2D drawings and 3D CAD models