

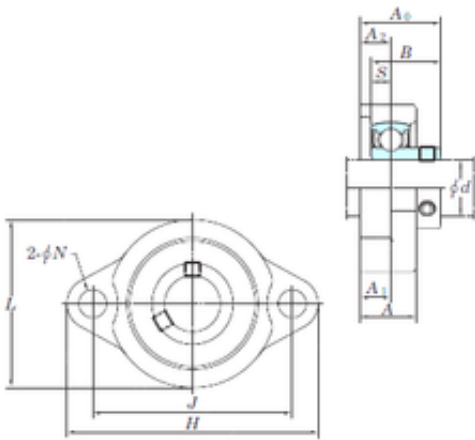

NACHI BEARINGS OF AMERICA CORP.

KOYO BLF207-23 bearing units

Bearing No. BLF207-23



BLF207-23 Bearing 2D drawings and 3D CAD models

Bore Diameter	36,5125 mm
d	36,5125 mm
A0	36,5 mm
A	24 mm
A1	13 mm
B	32 mm
H	122 mm
J	100 mm
L	89 mm
N	12 mm
S	8,5 mm
Bolt (G)	M10
A2	13 mm
Weight	0,77 Kg
Basic dynamic load rating (C)	25,7 kN
Basic static load rating (C0)	15,4 kN